



Installation Instructions

D760-0051 COLD AIR INTAKE SYSTEM

Document Revision: B
Revision Date: February 5, 2025

Table of Contents

Parts List	2
Vehicle List	3
Tools Required.....	3
Removal of Stock System	3
Airbox Assembly	4
Gasket Seal Installation	6
Airbox Assembly Installation.....	7

Thank you for being selective enough to choose a Dinan Performance Intake System. The Dinan engineering team has spent many hours developing this product to assure that you will receive increased performance, durability and an aesthetic design that you as a customer will be able to enjoy for many years. Ease of installation and maintenance is important to us and has been highly considered throughout the design process.

Prior to performing the installation, familiarize yourself with these instructions as it should help you with the process. If you feel that you do not have the required skills or tools, please arrange for a qualified repair facility to perform the installation.

If you have any difficulties during the installation, or if these instructions are not clear to you, please call Dinan's Technical Support Staff at (800) 341-5480.

Again, thank you for choosing Dinan. Enjoy.

Parts List

****Model view may not represent actual look of part. For reference only****

ITEM NO.	PartNo	DESCRIPTION	QTY.
1	D401-0022	Filter, Offset, 3.5"clamp, 5"OD, 4.875"L	1
2	D671-0147	Screw, M4x0.7x10, Button Head, SS	4
3	D671-0163	Washer, M4, Nylon, Blk	4
4	D762-0228	MAF; Air Flow Meter, Mini	1
5	D762-0229-G	Airbox Lid; Glossy, Mini	1
6	D763-0096	Gasket, Trim, U-channel, PushOn, 0.063"	40 in
7	N/A	Clamp: Included with Filter	1

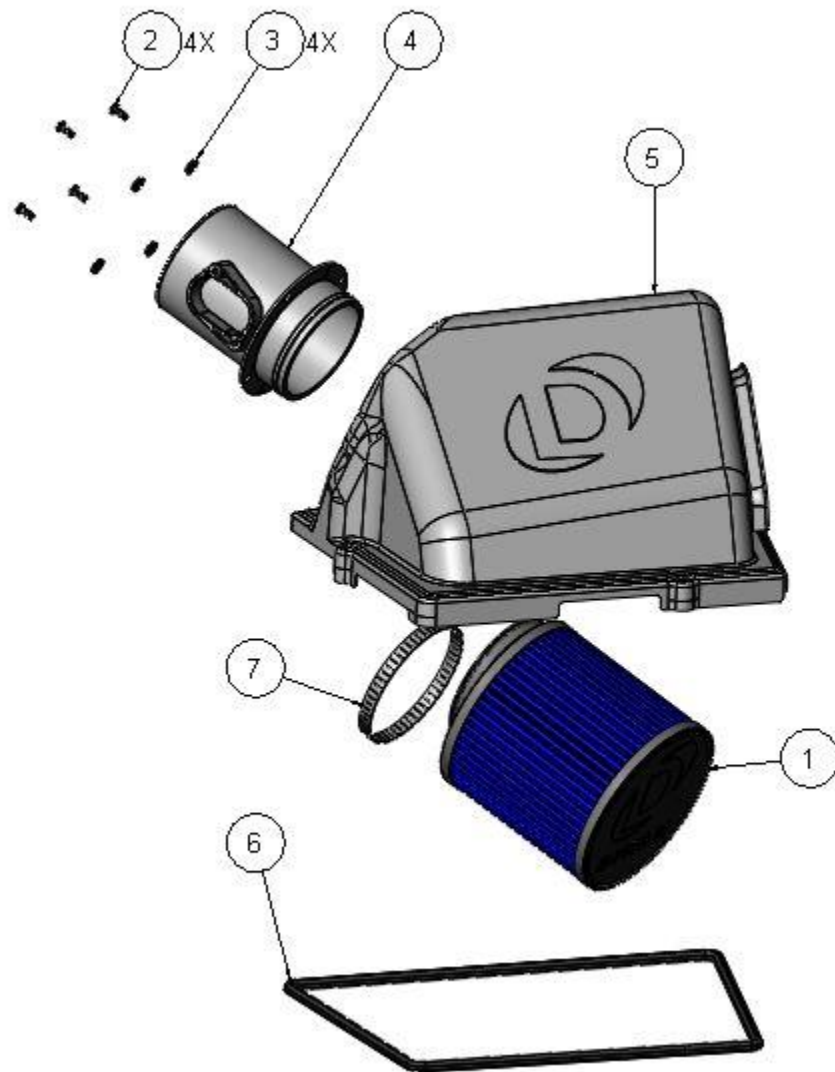

Vehicle List

- 2' F45 Active Tourer (11/2013 – 02/2018)
- 2' F45 Active Tourer LCI (05/2017 – 03/2019)
- 2' F46 Gran Tourer (07/2014 – 03/2018)
- X1 F48 (11/2014 – 04/2019)
- X2 F39 (10/2016 – 03/2019)
- MINI F56 (04/2013 – 03/2019)
- MINI F55 (09/2013 – 03/2019)
- MINI Clubman F54 (11/2014 – 03/2019)
- MINI Cabrio F57 (11/2014 – 03/2019)
- MINI Countryman F60 (11/2015 – 04/2019)

Tools Required

- T20 and T25 Torx bit
- 2.5mm Allen Key
- Flat head screwdriver

Removal of Stock System

- 1) (A) Loosen hose clamp.
- 2) (B) Remove grommet tab from upper airbox. This tab will not be re-installed on new airbox.
- 3) (C) Unplug and unscrew the air mass meter (2 screws) using a T20 Torx. ***These screws will be reused.***
- 4) (D) Unscrew the mounting screws (3 screws) of the airbox lid using a T25 Torx. ***These screws will be reused.***

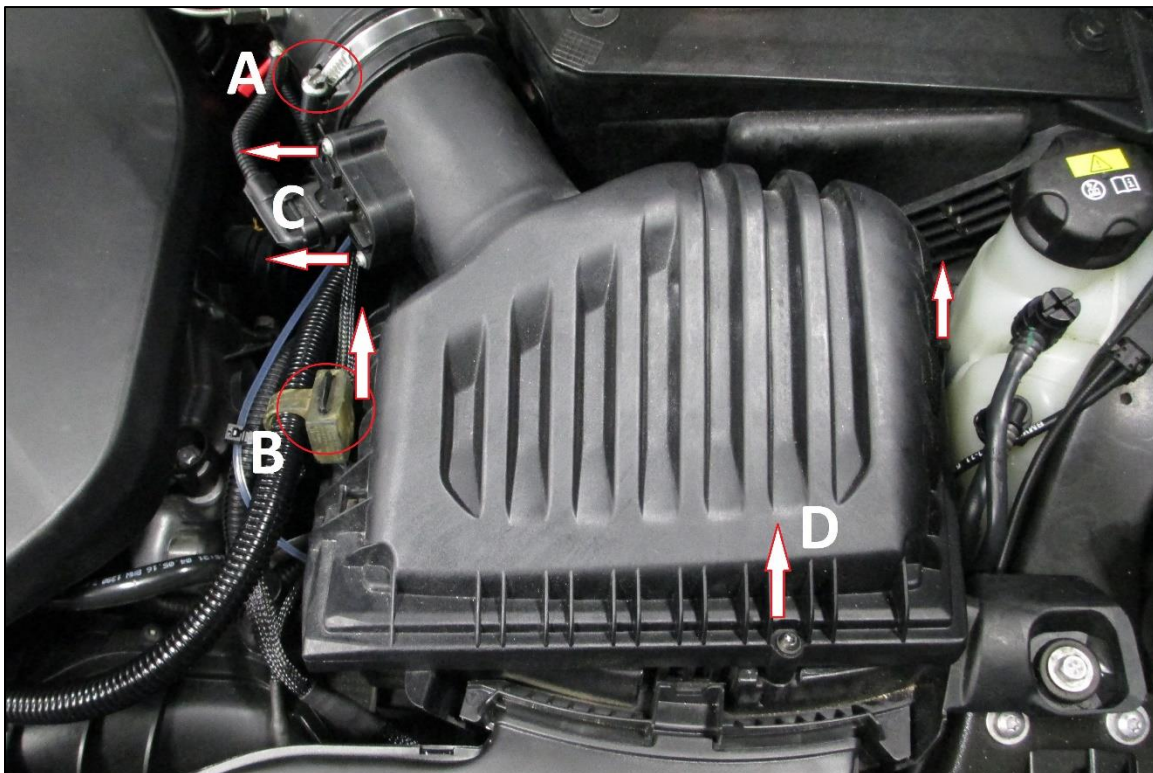

5) Remove airbox lid and filter from system.

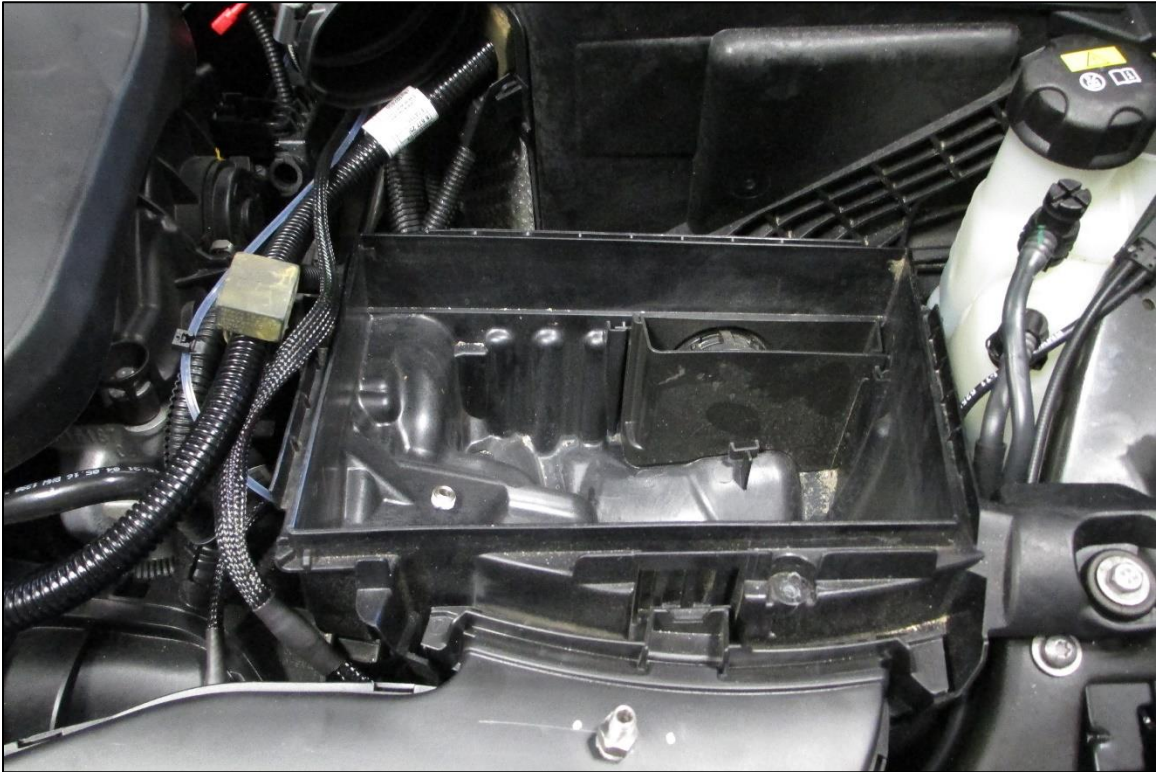

Airbox Assembly



- 1) Ensure the air flow meter side opening is in the orientation shown below. Using the 4 washers and 4 screws, hand tighten the mass air flow collar to the lid using the 2.5mm Allen key.



- 2) Install filter onto the air flow collar. The filter will fit over the collar and snap into place. The filter has an opening offset that allows it to be oriented in a specific location. Ensure the filter nests properly inside the air box.

Note - the air filter is a slight stretch fit onto the air flow meter. The “rib” on the collar fits into a recess in the air filter, to help lock it into place. Some resistance is to be expected during assembly. Please ensure that the hose clamp is adequately loose, to allow the filter to stretch onto the air flow meter.

- 3) Tighten the clamp.

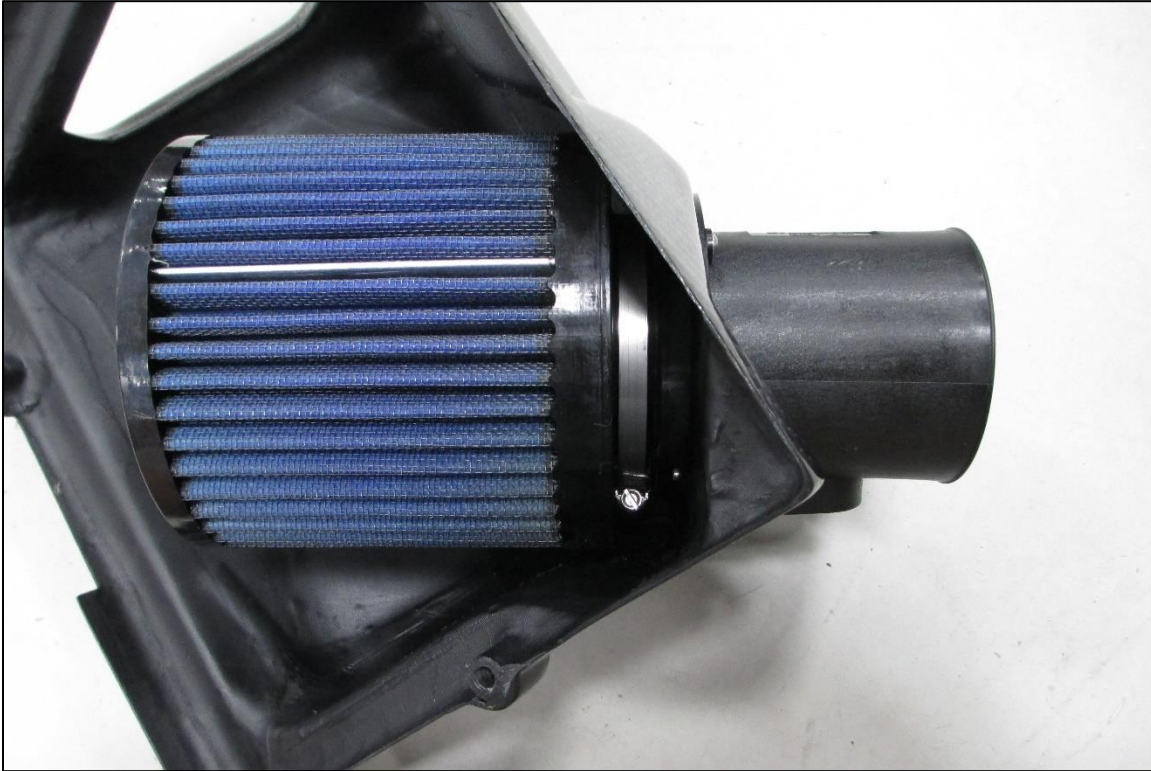

Gasket Seal Installation

- 1) Installation of this gasket will be mated to the inner lip of the lower installed airbox as shown below.
- 2) Using the supplied U-channel gasket, cut to length for each side of the airbox lid. Press fit on lip.

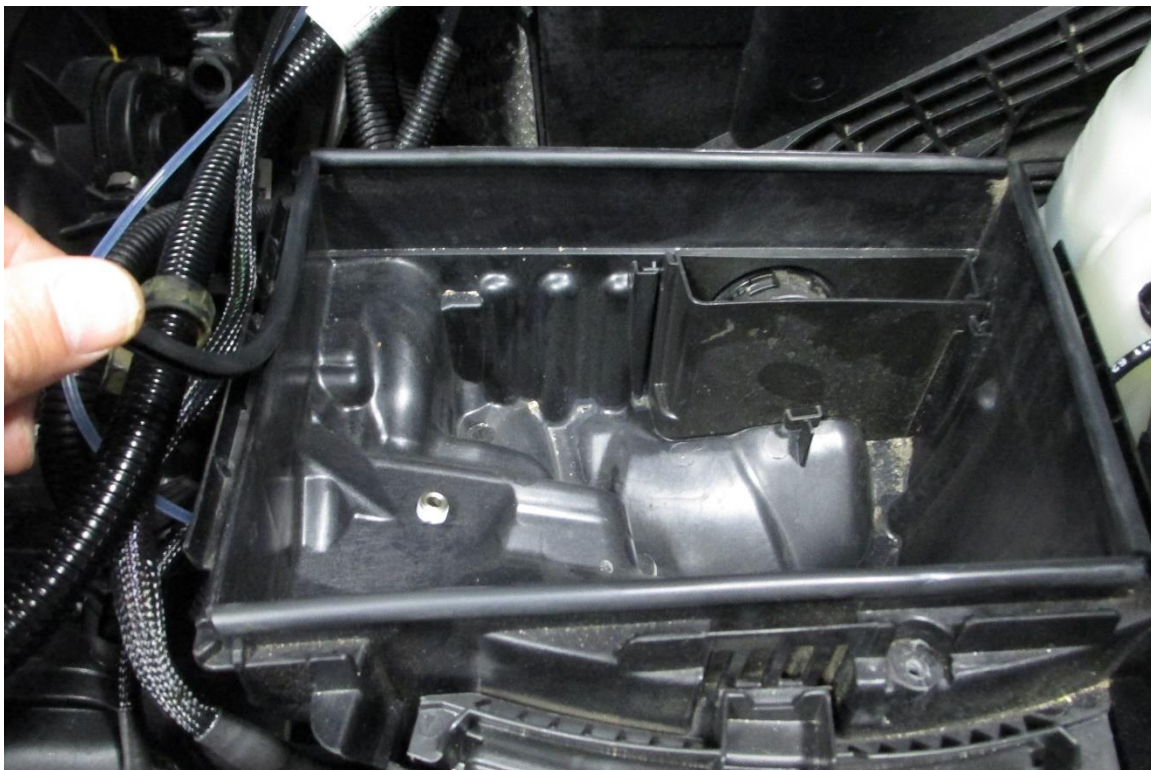

Airbox Assembly Installation

- 1) Slide air meter collar into tube.
- 2) Seat airbox properly against the lower lid.
- 3) (A) Hand tighten the 3 screws (T25 Torx bit), attaching the Dinan lid to the lower lid. *Do not over tighten.*
- 4) (B) Re-insert air flow meter, plug it back in, and tighten screws (T20 Torx bit). Mounting holes only align in one orientation.
- 5) (C) Tighten clamp.

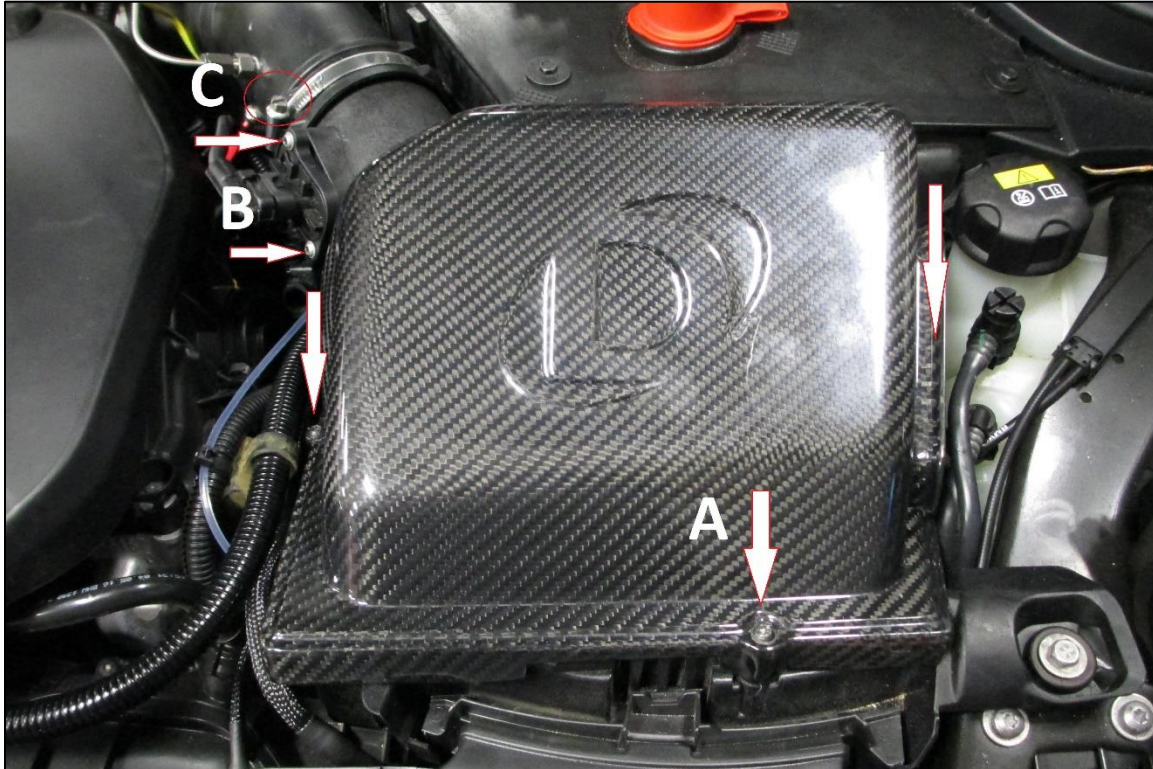

- 6) INSTALLATION IS NOW COMPLETE. ENJOY!