



Thank you for being selective enough to choose a Dinan Performance Intake System. The Dinan engineering team has spent many hours developing this product to assure that you will receive increased performance, durability and an aesthetic design that you as a customer will be able to enjoy for many years. Ease of installation and maintenance is important to us and has been highly considered throughout the design process.

Prior to performing the installation, familiarize yourself with these instructions as it should help you with the process. If you feel that you do not have the required skills or tools, please arrange for a qualified repair facility to perform the installation.

If you have any difficulties during the installation or if these instructions are not clear to you, please call Dinan's Technical Support Staff at (800) 341-5480.

Again, thank you for choosing Dinan. Enjoy.

Installation Instructions

D760-0049 2018-21 F90 M5 COLD AIR INTAKE SYSTEM

Document Revision: A
Release Date: February 19, 2021

Table of Contents

Parts List	2
Vehicle List	3
Tools Required	3
Removal of Stock System	3
Air Duct Radiator Cap Modification	6
Scoop Panel Installation	7
Airbox Lid Assembly	9
Airbox Assembly Installation	12
Brace / Hood Latch Cable Installation	13
Seal and Gasket Installation	14
Snorkel Installation	15
Enjoy	16

Parts List

Model view may not represent actual look of part. For reference only

ITEM NO.	PartNo	DESCRIPTION	QTY.
1	#70Z	CLAMP 9MM, 100-120mm	2
2	D401-0026	Air Filter	2
3	D671-0147	M4 x 10 x 0.7P Button Head, SS	12
4	D671-0163	Washer, M4, Nylon, Blk	12
5	D762-0223	Outlet Airflow Collar	2
6	D762-0224	Scoop Panel	1
7	D762-0225	Snorkel Inlet Tube	1
8	D762-0226	Gasket, Wiper	2
9	D762-0227	Gasket, Sealing	1
10	D763-0095	Foam, EPDM Strip, .375" x .750"	30 in
11	D763-0096	Gasket, Trim, U-Channel, Push On, 0.063"	80 in
12	D763-0221	Airbox Lid, Left F90 w/ HCA	1
13	D763-0222	Airbox Lid, Right F90 w/ HCA	1

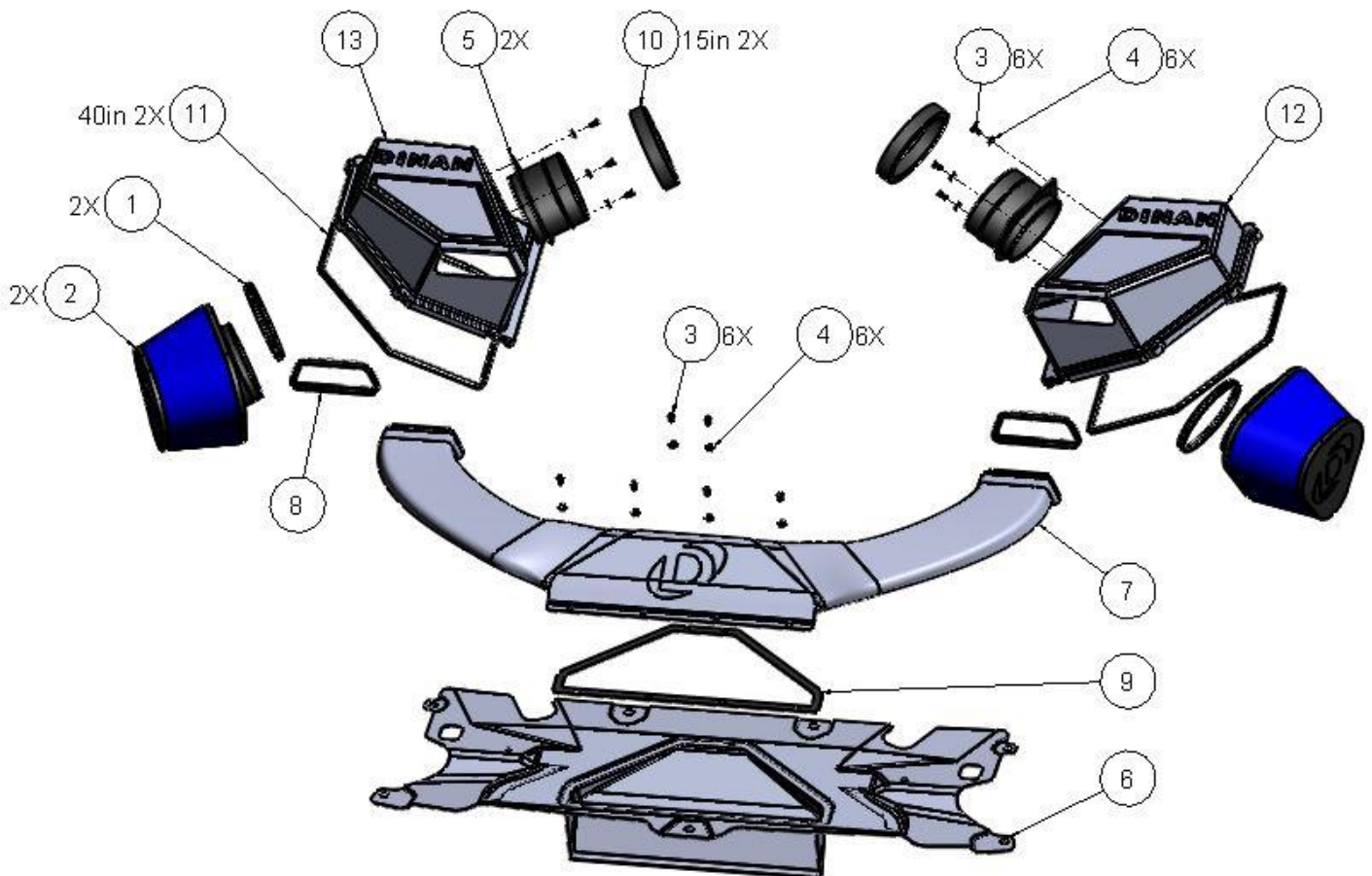

Vehicle List

- 5' F90 M5 (02/2016 —)

Tools Required

- Required Tools
 - 16mm socket
 - 18mm socket
 - T25 and T30 Torx bit
 - 2.5mm Allen Key
 - Cutting shears or Dremel tool with cutoff wheel
 - Flathead or Phillips head screwdriver
 - Pliers or other suitable tool to remove expanding rivets

Removal of Stock System

- Removal: Engine Compartment Cover(s):
 - Pull out the 3 expanding rivets shown below.
 - Detach the cover from the front engine hood seal.
 - Repeat on other side of vehicle.



2) Removal: Airbox Assembly

- a) Loosen clamps and remove (A) from the system.
- b) Remove outside acoustic cover (C) from vehicle.
- c) Remove bolts of strut tower brace (B) using a 16mm and 18mm socket.

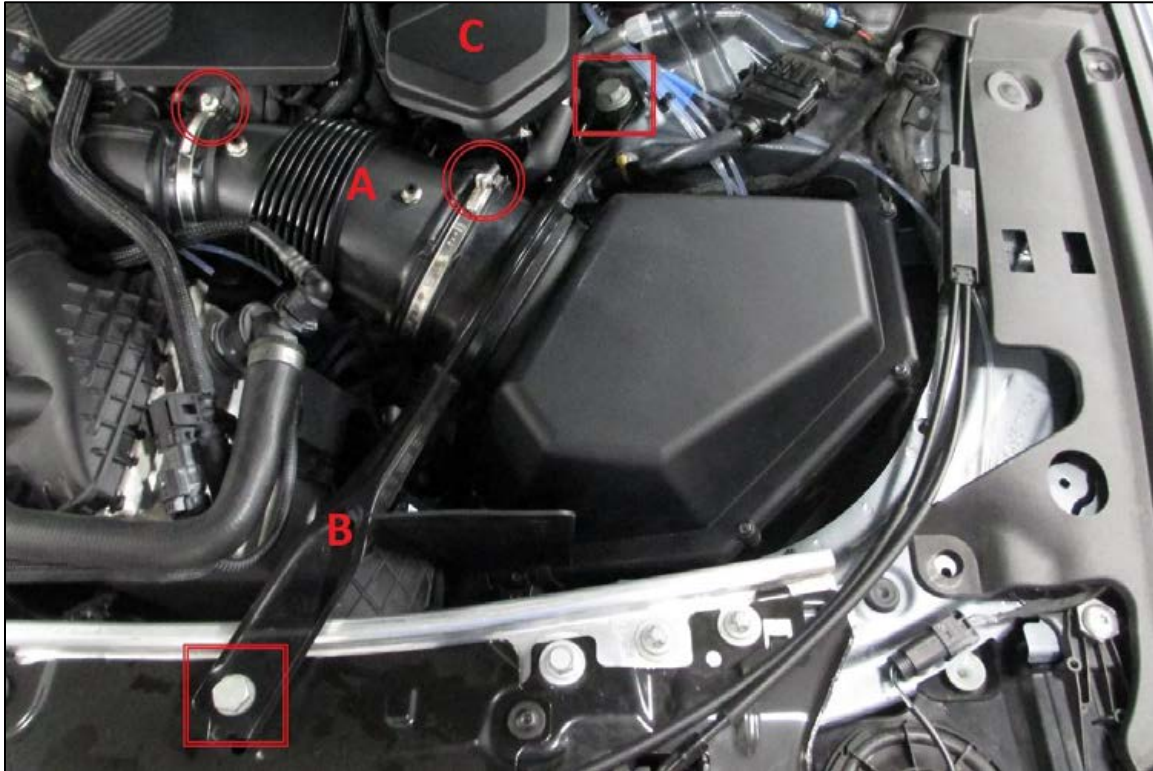

- d) Ensure all hoses, located under the brace and/or attached to the airbox lid, are free from lid.
- e) The airbox is snapped into the car and can be removed by pulling up on entire airbox (top and bottom lid). Some force may be required.



- f) Repeat same process on other side of vehicle.

Removal: Crosslink Front Panel

- g) Unclip hood latch cable from panel (square symbol).
- h) Remove 7 screws using a T30 Torx bit (circle symbol). These parts will be re-used.
- i) Remove radiator vibration mounts by unsnapping from panel (pentagon symbol). These parts will be re-used.

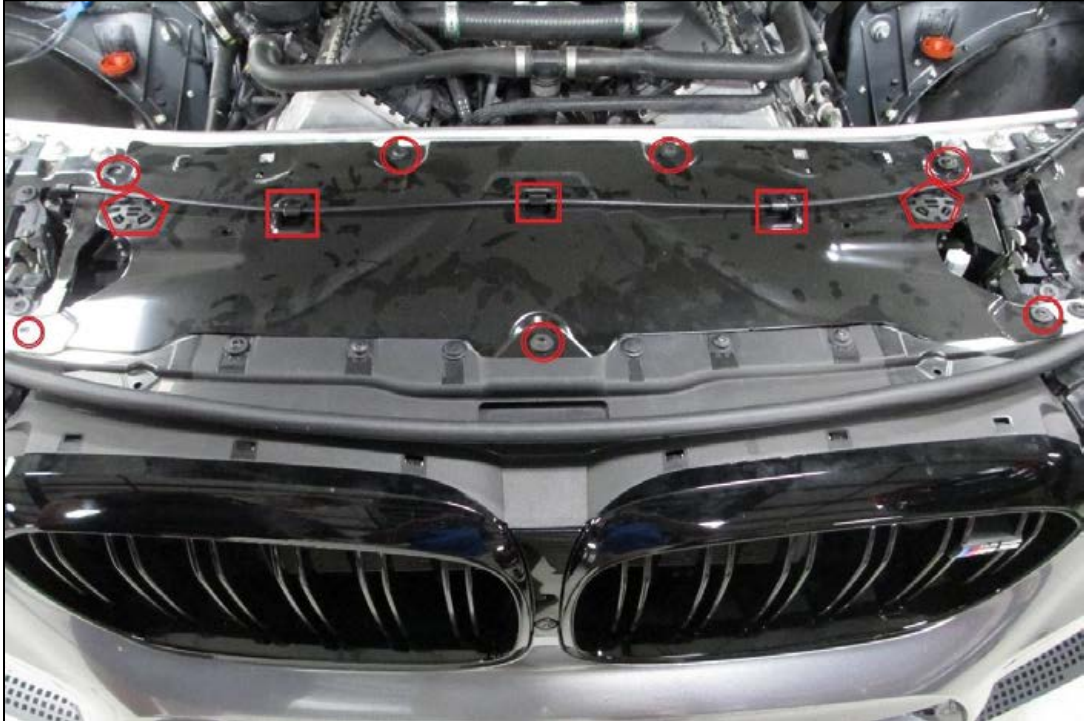

Air Duct Radiator Cap Modification

The addition of the Dinan Scoop Panel requires a cut modification to the air duct radiator cap. This can be completed without removal from the vehicle.

It will be better to cut slightly short on the sides to ensure that the part will slide in easily and center itself in the vehicle. A snug fit is recommended to help maintain the seal of the grille air duct.

- 1) Measure and scribe the section to be removed. A total width of 13.75" is needed to properly install the Scoop Panel. This should be done from the center line of the vehicle (6.875" each side) as denoted by the orange line in the below image.



- 2) The sides shall be cut parallel to the centerline of the vehicle. This can be done with cutting shears or a rotary tool with a cutting wheel attached.
- 3) The front lip of the of the air duct radiator cap should be cut with a cutting wheel to achieve the best results. Make sure that the material removed is flush with the metal lip when looking from top down. This will allow the scoop to fit down into the grille air duct.
- 4) Clean up edges if necessary and discard cutout piece.

Scoop Panel Installation

- 1) With the air duct radiator cap properly cut out, the scoop should slide into the opening.
- 2) Slide the scoop panel under the hood latch cable.



- 3) Due to manufacturing tolerances, adjustment of the aluminum plate as shown below may be needed. Loosen the screws (2), one on each side. This plate can be adjusted slightly if needed to allow alignment of the scoop panel holes. Again, if needed. Retighten screws.



- 4) Reuse screws from the removal of the stock panel to secure the scoop panel. Tighten the screws.



- 5) Re-insert radiator vibration mounts. These will snap into the panel. Pay attention to orientation as pictured below.



Airbox Lid Assembly

- 1) Disassembly of Stock Airbox
 - a) Remove the screws holding the top airbox lid to the lower airbox lid using a T25 Torx bit.
 - b) Save the lower airbox and screws as they will be re-used during Dinan Intake installation.
 - c) The rubber flap from driver side airbox will NOT be re-installed.



- 2) Rubber Seal Installation
 - a) 2- 40in of the rubber seal has been supplied. This will need to be trimmed but not until the seal is mostly installed.
 - b) Start in the corner shown and work around perimeter ledge. Sharper corners will seat properly but may need some patience.



- 3) Filter Assembly: same process for both driver and passenger airbox lids.
a) The following steps will be repeated for both left and right lid assembly.



- b) Attach outlet collar to lid with washer and screws using a 2.5mm Allen wrench.



Install clamp and filter. Work the filter around the collar from the inside. Orient clamp as shown. Tighten clamp.



c) Install the airbox lid assembly onto the lower airbox. Reuse the screws from the stock assembly (6 places per airbox lid).

****DO NOT OVER TORQUE. HAND TIGHTEN FOR SNUG FIT AGAINST CARBON****



- d) Apply foam tape to collar as shown. Cut to length for each side. Use the lip on the collar as a guide line for installation. The strut tower brace will slip over this during installation.



Airbox Assembly Installation

- 1) Correctly install the strut brace over the foam.
- 2) Slide the assembly into the engine bay.
 - a) Ensure all cables and pipes are out of the way before installing.
 - b) Make sure that the lower lid opening slides over the air duct opening properly.
- 3) Align the fastening plugs and grommets. With some downward pressure, the assembly should snap into place.

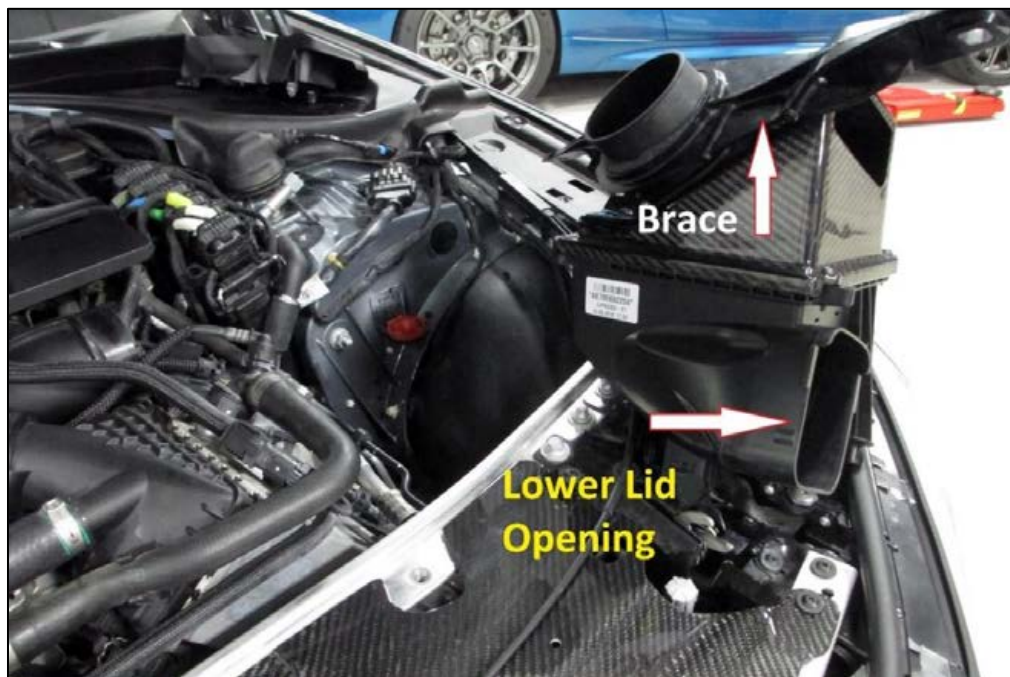

- 4) Reinstall the flex tube for both sides and tighten all the clamps.



Brace / Hood Latch Cable Installation

- 1) Route the hood latch cable under the strut braces. The cable should have some slack in it.
- 2) Reuse the bolts from removal to mount the strut braces. Torque the front bolt to 20 ft.lbs (28Nm) and the rear bolt to 40 ft.lbs (56Nm).

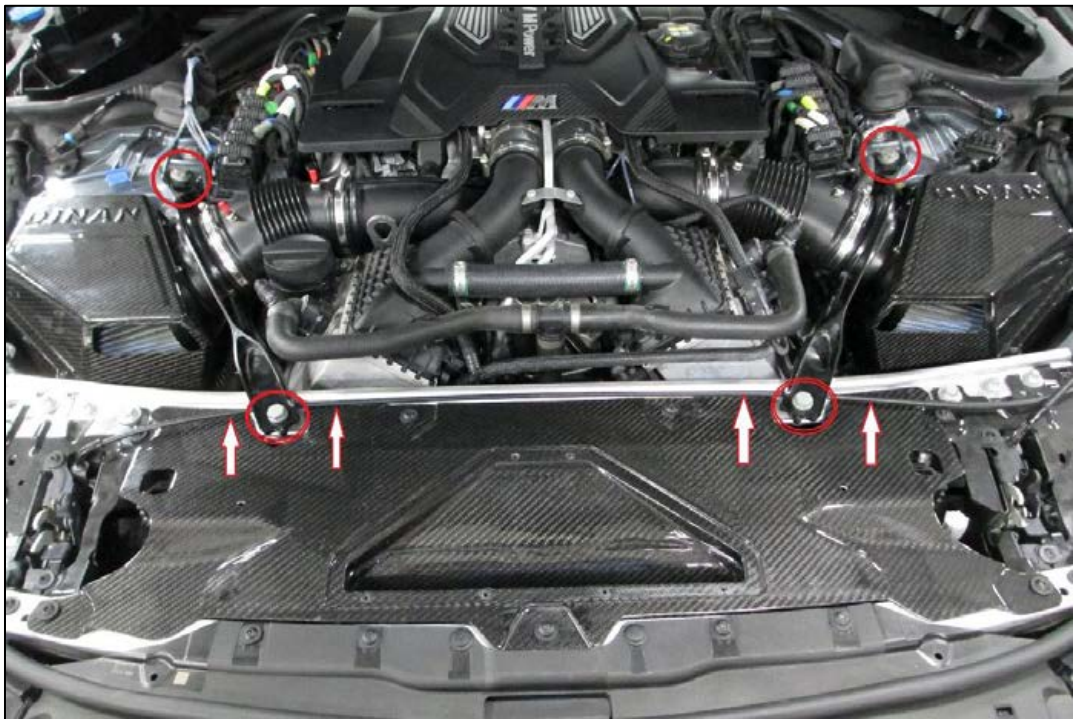

Seal and Gasket Installation

1) Wiper Seal Installation

- a) Insert the wiper seal into the opening at the front of the housing in the orientation shown below.
- b) The seal should sit flush on the front surface.
- c) Repeat on the other side of the vehicle.



2) Snorkel and Panel Gasket Installation

- a) Peel off the adhesive backing tape and attach the panel gasket as shown below.
- b) Align 6 mounting holes with holes cutout of the gasket and install it parallel to edges.
- c) Press firmly in place.



Snorkel Installation

- 1) Reinstall the engine compartment covers on both sides.
 - a) Ensure the panel snaps into hood gasket.
 - b) Re-insert the expanding rivets.

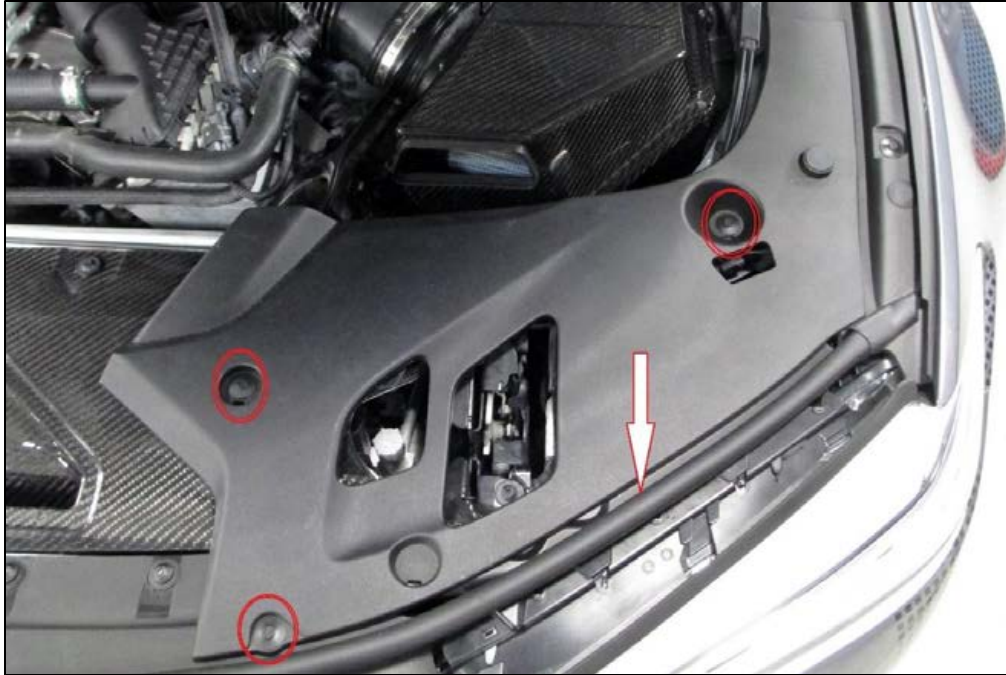

- 2) Slide both sides of the snorkel into the wiper gasket opening of the airbox lids. Ensure that the gasket evenly surrounds the carbon tube.
- 3) Fit and press the carbon tube into the airbox. Move up/down and side/side to help it seat properly.



- 4) Fasten the snorkel to the panel using the provided washers and screws as noted on page 2 (6x).
 - a) You may need to push the snorkel towards engine during screw installation.
 - b) Start the thread of all 6 screws prior to final tightening.
 - c) Hand tighten all the screws.



- 5) Reinstall the acoustic covers.



Enjoy

Installation is now complete. Clean the carbon fiber with a microfiber cloth and ensure any tools are removed from engine compartment prior to closing the hood.